





North Street, Wellington, TA21

Approximate Area = 632 sq ft / 58.7 sq m

For identification only - Not to scale

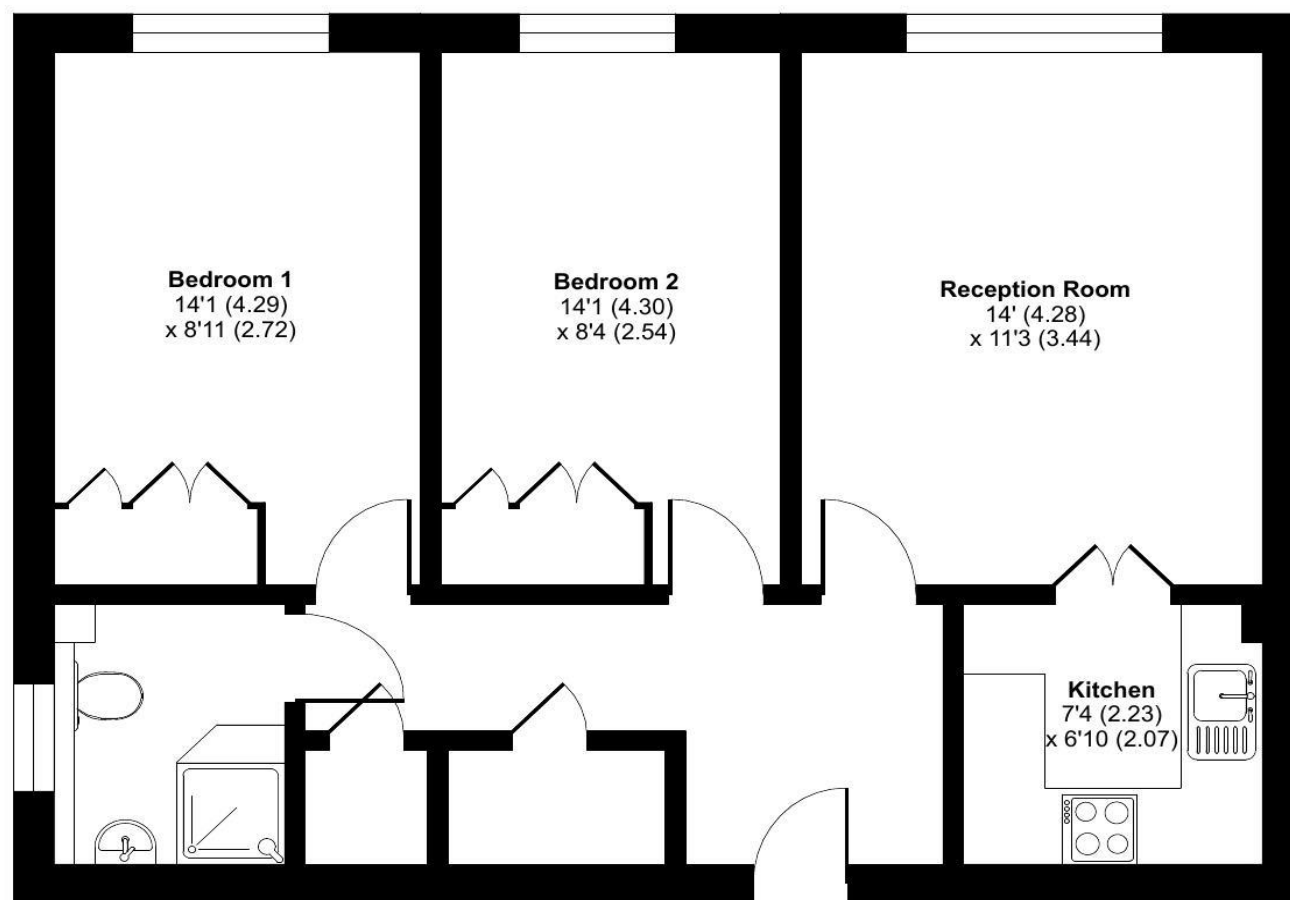

FIRST FLOOR

Floor plan produced in accordance with RICS Property Measurement 2nd Edition, Incorporating International Property Measurement Standards (IPMS2 Residential). © nchecom 2026. Produced for Jeffrey Limited T/A Wilkie May & Tuckwood Wellington. REF: 1402376

33 Bishops Court is a two bedroom second floor retirement apartment situated in the centre of the town of Wellington within easy walking distance of all amenities. The property is offered to the market with NO ONWARD CHAIN. The development benefits from a communal garden, resident's lounge, laundry room, guest suite and resident's parking.

The accommodation briefly comprises an entrance hall with two large built in storage cupboards, spacious sitting/dining room and a kitchen accessed via double doors and fully fitted with a range of modern wall and base units with an integrated oven and hob and space for a fridge/freezer. There are two bedrooms alongside a modern shower room fitted with a white three piece suite with walk in shower.

Outside of the development there are communal gardens which are well maintained with various areas to sit out and relax in the warmer months. Some areas of the garden are accessed via steps.

There is a secure entrance system for residents with an automatic front door key fob and normal key operated side doors. By the front door there are charging ports for mobility aids which is agreed/arranged by the Manager. There is a residents sitting room which is nicely furnished with an adjoining kitchenette where regular coffee mornings and activities are held.

The guest suite is available for family and friends and will need to be pre-booked, and there is a nominal charge for the use of this. The laundry room has a selection of washing machines and tumble dryers which can be found on the lower ground level of the development.



- Two bedroom retirement apartment
- Communal gardens
- Residents' lounge, parking, laundry room and guest suite
- Close walking distance to the town centre
- NO ONWARD CHAIN